

INTELLY 1204 - 1505 - 2006

Horizontal multistage pump with integrated inverter control HIGH FLOW



Technopolymer check-valve with flow control disc and calibrated spring in AISI 316

Description

INTELLY uses the most advanced Steelpumps technologies, to allow for pressure constant according to the request and consequently an optimization, also ensuring a reduction of noise. The presence of a communication display, the choice of the pump operating point, it turns out very simple, intuitive and feasible without special programming. Protection against dry-running antiblocking system every 72 hours of pump inactivity. The pump ensures comfort of pressure constant (adjustable set point) in the system and a great energy savings.

Applications

- Domestic boosting
- Irrigation
- Water treatment plants
- Industrial washing and cooling
- Use of rainwater
- Depth max 5 m

Pumped liquid:

Clean water without any abrasive or suspended solids

Liquid temperature +2°C ÷ +40°C

Air temperature Max +45°C

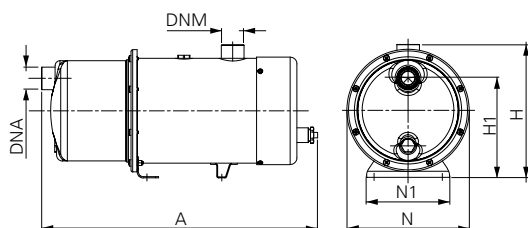

Materials

- Pump body and motor in AISI 304
- Brass motor flange
- Shaft in AISI 420
- Diffuser Technopolymer Noryl
- Impeller Stainless Steel AISI304
- Dumping feet: rubber
- Mechanical seal: ceramics / graphite
- A2 Bolts
- NBR70 O-ring
- ADB LIYY-HZO Electric cable 10m length
- Inverter electronic board according to Rohs standards
- Class F insulated motor
- Control box with display
- Plastic flow sensor

Code	P ₂ Nom.		1 ~ 50Hz Amp.	Stages	Q (l/m) FLOW							Dimensions mm						Weight Kg	
	kW	Hp			0	30	50	70	100	120	145	A	H1	H	N	N1	DNM		DNA
	230 V		Total Hm in CA																
INTELLY 1204	0,90	1,2	8,8	4	43	38	34	30	24	16	6	560	165	226	200	136	1"¼	1"¼	21
INTELLY 1505	1,10	1,5	9,8	5	51	46	43	38	30	21	9	715	165	226	200	136	1"¼	1"¼	23
INTELLY 2006	1,50	2,0	12,5	6	62	55	51	45	34	24	10	715	165	226	200	136	1"¼	1"¼	24



Curves and performance $n = 2900$ 1/min

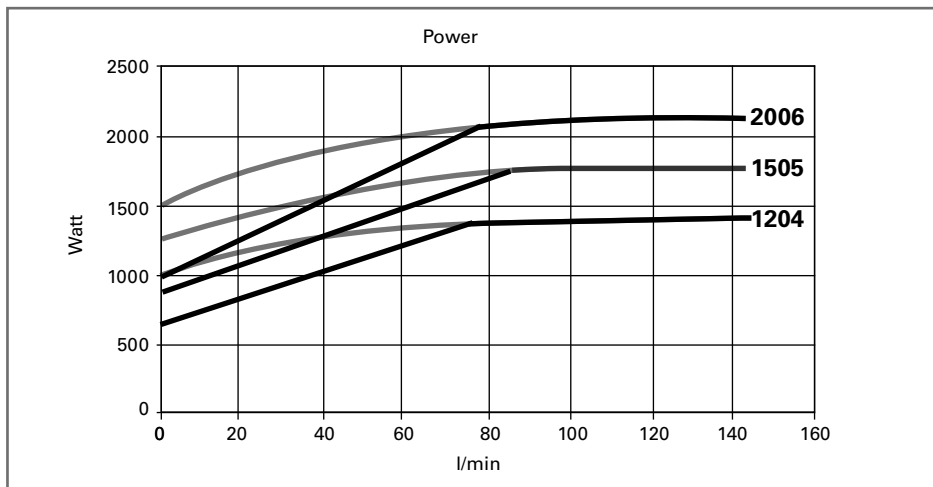
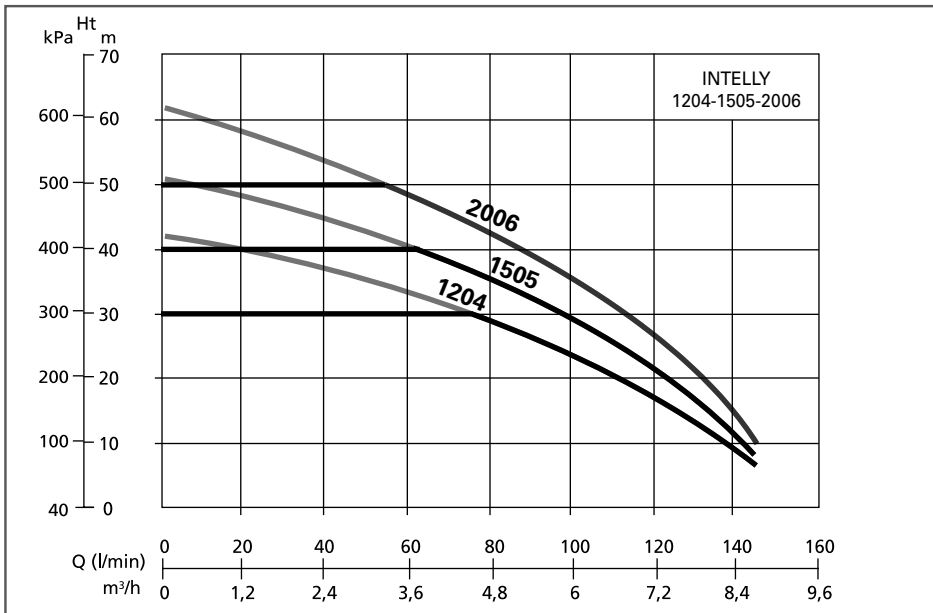

INTELLY Control Panel
With fast connector



Technopolymer impeller



Motor body with delivery
mouth



Brass motor support

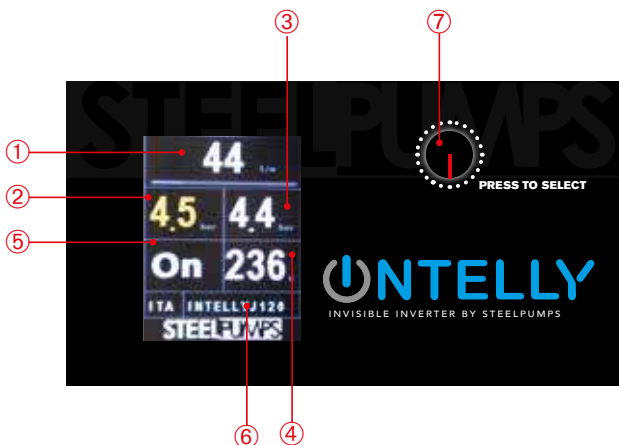

- 1 - Flow detected
- 2 - Pressure detected
- 3 - Set pressure (Fail Safe)
- 4 - Supply voltage
- 5 - Pump status
- 6 - Pump model
- 7 - Programming button



Electronic board